

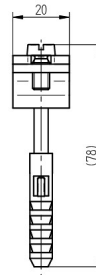

ELIT BLH-V2A-30MM-FLAT

Tape conductor holder in stainless steel for 30



Tape conductor holder in stainless steel for 30 mm wide flat strip, with screws M6

Technical description

Stainless steel strip conductor holder for 30 mm wide flat strip, with M6 screws.
Height of conductor guide: 15 mm
Dowel fitting: Ø 8 mm
According to EN 62561-4

Advantages:

Weatherproof stainless steel strip conductor holder
Suitable for 30 mm wide flat strip
Height of conductor guide: 15 mm
According to EN 62561-4

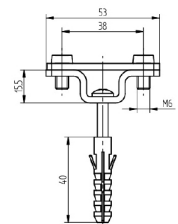

Product name/ Art.nr/ GTIN	ELIT BLH-V2A-30MM-FLAT/ 40160041/ 7070810040636
According to:	DIN EN 62561-4
Type of accessory/spare part	Mounting material
Accessory	Yes
Material	Stainless steel 304 (V2A)
Surface protection	Hot-dip galvanized